

Service Bulletin

Bulletin No. 02-07
March 30, 2007

To: ITW Ransburg and ITW Automotive Finishing Distributors
Subject: RMA-303 Indirect Cup Wash

An improvement has been made in the routing of the cup wash solvent through the Atomizer Body (P/N A11697-00) of the RMA-303 Indirect. The improvement necessitates the addition of one (1) part to the (P/N A11300) and (P/N A11600) assemblies and changes the part number of one (1) other part included in these assemblies.

The additional part required is a "Y" Fitting (P/N A11894-00) that screws into the Valve Manifold Assembly (P/N A11348-00) in the Cup Wash (CW) hole. The existing Cup Wash Tubing Assembly (P/N A11351-03) then attaches to either outlet hole of the "Y" Fitting, using the Nut and Ferrule, as shown in Figure 1. No changes have been made to the other attachment point - it is attached to the rear of the Atomizer Body to the CW hole using the Nut and Ferrule.

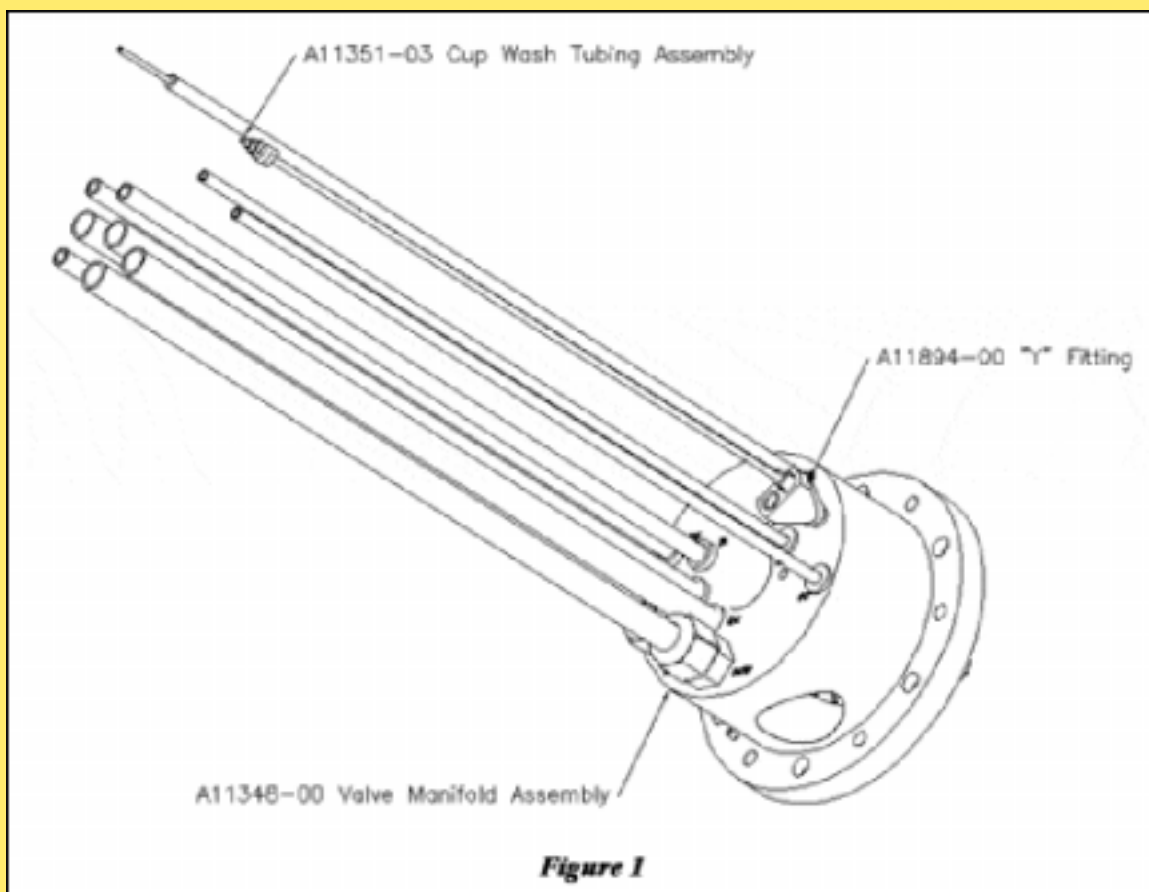

The changed part is the Cup Wash Tube Assembly (P/N A11351-02) and it is replaced by the Cup Wash Tube Assembly (P/N A11351-04). The Cup Wash Tube Assembly (P/N A11351-04) is installed by passing the tube through the Atomizer Body (P/N A11697-00) as shown in Figure 2. Two (2) Nuts and Two (2) Ferrules are installed on the front end of the Tube Assembly and one (1) Nut and one (1) Ferrule is installed on the rear of the Tube Assembly (after it is slid through the Atomizer Body). The front end is then attached to the Shape Air Ring and the Atomizer Body, using the Nuts and Ferrules, and the rear end is attached to the remaining hole in the previously installed "Y" Fitting using the Nut and Ferrule.

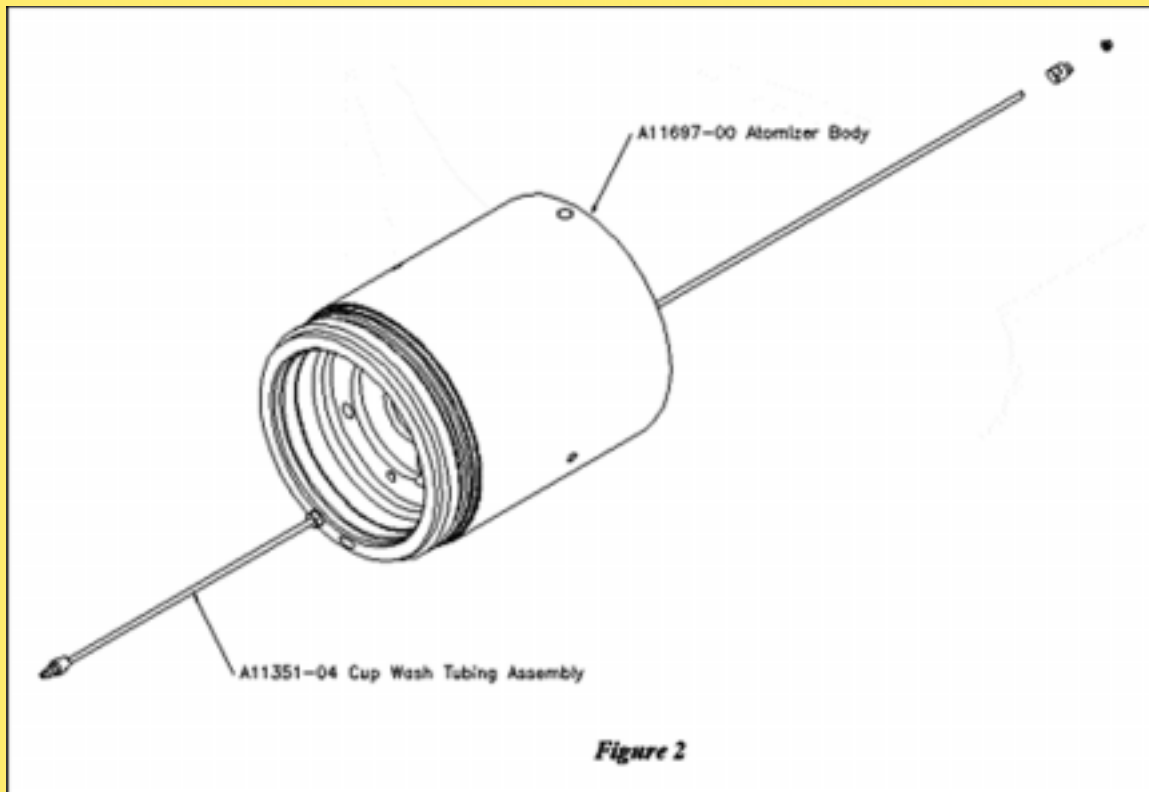

Figure 2