

SERVICE INSTRUCTION

79847 Atomization Air Compensation Valve (Vector Solo 79900)

The Vector Solo 79900 series applicators have two options for atomization air control. The first option comes installed in the applicator when shipped from the factory. This is 79847-01 Plug for the atomization air port. This plug should be hand-tightened into the port. The 79847-01 is depicted in Figure 1.

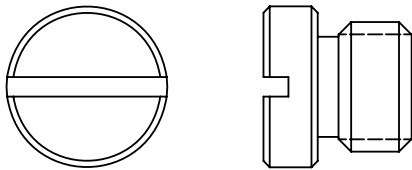

Figure 1: 79847-01 Factory Installed Atomization Port Plug

The second option for atomization air control is packaged with the 79900 Applicator Assembly when shipped from the factory. This is 79847-00 Compensation Valve for the atomization air. The 79847-00 is depicted in Figure 2.

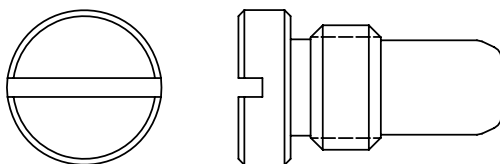

Figure 2: 79847-00 Atomization Air Compensation Valve

Using the 79847-00 Atomization Air Compensation Valve allows the user to adjust the atomization air 3 psi per turn, maximum 3 turns from flush position. The use of 74035-27 65V Air Cap Test Kit is recommended to determine the fan and atomization air pressure in the applicator. Adjusting these pressures is necessary for optimal spray performance.

To adjust the 79847-00, use a flat-head screwdriver to screw the valve in (decreasing the atomization air pressure) or out (increasing the atomization air pressure).

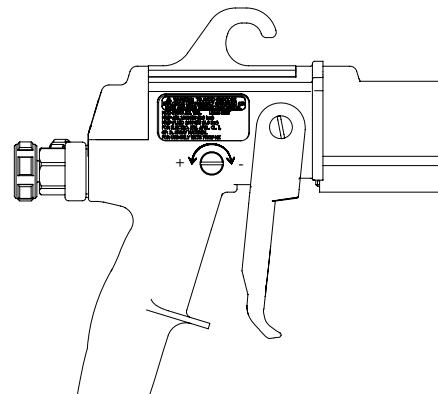

Figure 3: 79847-00 Installed in the 79900 Vector Solo Applicator

Manufacturing

1910 North Wayne Street
Angola, Indiana 46703-9100
Telephone: 260/665-8800
Fax: 260/665-8516

Technical/Service Assistance

Automotive Assembly and Tier I
Industrial Systems
Ransburg Guns
www.itwransburg.com

Telephone: 800/ 626-3565 Fax: 419/ 470-2040
Telephone: 800/ 233-3366 Fax: 419/ 470-2071
Telephone: 800/ 233-3366 Fax: 419/ 470-2071

Technical Support Representative will direct you to the appropriate telephone number for ordering Spare Parts.

© 2008 Illinois Tool Works Inc. All rights reserved.
Models and specifications subject to change without notice.



Form No. SI-08-03
Litho in U.S.A.
04/08

